

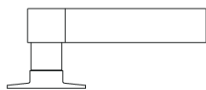

## Nº 2096FBA

The No 2096FBA represents the purity of modern design enriched with fine sophistication. A thin planar handle runs tangent to a cylindrical shank which is crowned with a faceted black agate. The circular rose with concealed screws infuses the lever's ideal forms with a functional aesthetic. This lever can be used with traditional full-mortise locksets or manufactured for use with multi-point doors and tilt & turn windows. All Nanz plated and patinated [finishes](#) are available.

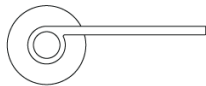

Length: 4-5/8"  
Projection: 2-3/8"  
Rose Diameter: 2-1/4"  
Lever Style: Modern