

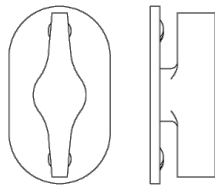

Nº 4921

The Nº 4921 is designed to emphasize elegant fluidity and modern simplicity. Geometric in shape, this thumbturn is a harmony of form and function and pairs with the No 2921 lever, based on a design by Gio Ponti from the 1950s. All Nanz plated and patinated [finishes](#) are available.



Projection: 5/8"

Height x Width: 1-3/4" x 1"