

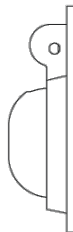

N° 6171

The N° 6171 flush ring pull is available in six sizes. It is often specified for marine use and anywhere flush installation is essential. As with all Nanz products it is available in a variety of plated and patinated finishes.

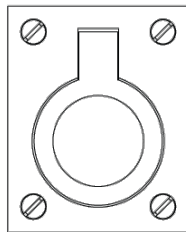

Height:	1-1/4"	1-1/2"	1-7/8"
Width:	1"	1-1/4"	1-1/2"
Projection:	5/64"	5/64"	5/64"
Depth:	1/2"	1/2"	1/2"
Collection:	Bauhaus		

NEW YORK BOSTON CHICAGO MIAMI LOS ANGELES SAN FRANCISCO LONDON

THE NANZ COMPANY 121 VARICK STREET NEW YORK NY 10013 212 367 7000 NANZ.COM

© 1989-2017 ALL RIGHTS RESERVED