

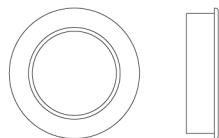

N° 6429

The ogee ornament of the No 6429 Georgian pull is evocative of the Neoclassical 1920s. Simple in design, the pull becomes a focal point on pocket or Harmon hinge doors. Alternative designs are available with ornamentation that compliment other hardware suites. The rounded recessed pull is two-pieced and available in a variety of finishes, including polished nickel, burnished brass, pewter, antique brass, and dark oxidized bronze.

81149



Diameter: 3-3/4"

Projection: 1/8"

Depth: 11/16"

Collection: Modern